

## ANCHORS

# STANCHION, RAIL, & LADDER



Stainless steel, bronze, and copolymer anchors for Stanchion Posts, Rails, and Ladders

### Wedge Anchors:



#### 4" STANDARD-DUTY BRONZE WEDGE ANCHOR

For rails, ladders and other deck equipment.

**24010-00 - 4" BRONZE ANCHOR FOR 1.90" RAILS**

**54052 - 4" BRONZE ANCHOR FOR 1.50" RAILS**



#### 6" STAINLESS STEEL WEDGE ANCHOR

Stainless steel wedge anchor for 1.50" O.D. railings. Body is 6" deep and is 304L cast stainless steel; wedge is cast bronze and hardware is 304L stainless steel.

**24090 - STAINLESS STEEL WEDGE ANCHOR FOR 1.50" RAILS**

### Stanchion Anchors:



#### 6" BRONZE STANCHION ANCHOR

For 1.90" O.D. stanchions posts and other pool deck equipment.

**23638-00 - BRONZE 6" ANCHOR KIT, 1.90" - Includes anchor, lid and key.**



#### 6" STAINLESS STEEL STANCHION ANCHOR

For 1.90" O.D. stanchions posts and other pool deck equipment. Made entirely of 316L grade stainless steel.

**24060-00 - 316L STAINLESS STEEL STANCHION ANCHOR KIT, 1.90" - Includes anchor, lid and key.**

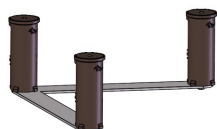

#### TAGLINE STANCHION ACHOR

Used for a tagline stanchion. Pools that have a longer width that require more tension on the backstroke flag lines.

**1810360- TAGELINE ANCHOR KIT STANCHION BRONZE**

## ANCHORS

# STANCHION, RAIL, & LADDER



Stainless steel, bronze, and copolymer anchors for Stanchion Posts, Rails, and Ladders

### Compression Anchor:



#### 6" SPECTRA LOCK™ COPOLYMER COMPRESSION ANCHOR

Engineered to address corrosion issues in pool environments and provide easier rail and ladder installation, 1.50" O.D.

- Made of copolymer
- Reduces maintenance costs & cleaning time
- Eliminates debris, corrosion, and heavy water deposits typically found lodged between the wedge anchor inside wall and assembly ideal for underwater installation of handrails and ramp rails where rust bleeds can lower water quality
- Ideal for removing and installing ladders or rails during pool deck maintenance, repairs, and renovation
- Eliminates alignment issues and the need for frequent bolt tightening common with wedge anchor assembly
- Standard colors: black, white, bone, traffic grey.
- Available in custom colors
- Built-in anchor compression ring applies even pressure on tubing, decreasing potential damage to rail or ladder
- Escutcheon-less, flush-mount design gives the rail and deck a finished look
- Accommodates recommended ADA compliant handrail and ladder tubing diameters
- Protected by U.S. Patent 7437857

**42696 - SPECTRA LOCK™ COMPRESSION ANCHOR, 1.50" - BLACK**

**42696-W - SPECTRA LOCK™ COMPRESSION ANCHOR, 1.50" - WHITE**

**42696-TG - SPECTRA LOCK™ COMPRESSION ANCHOR, 1.50" - TRAFFIC GREY**

**42696-B - SPECTRA LOCK™ COMPRESSION ANCHOR, 1.50" - BONE**