

Dual Post Xcellerator™

Part Number 133171

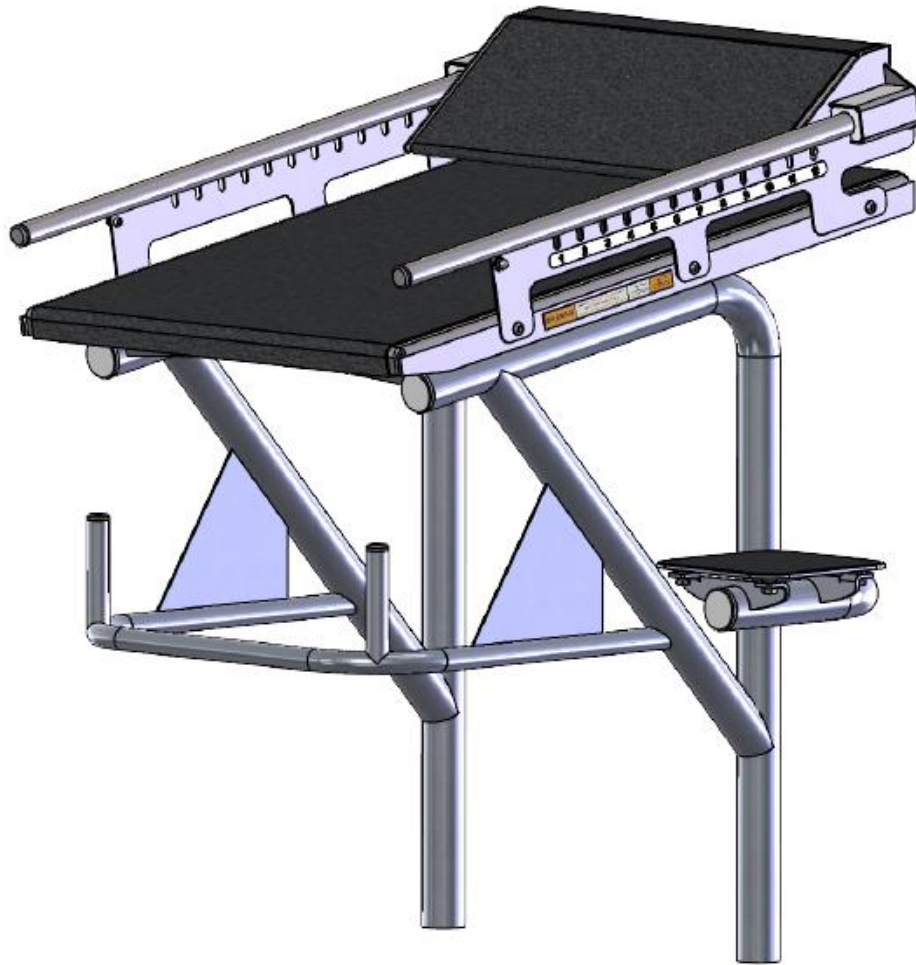

SPECTRUM[®]
Aquatics
A **PLAYCORE** Company

7100 Spectrum Lane ~ Missoula MT 59808
800.791.8056 ~ www.spectrumproducts.com

You have purchased a Spectrum Products Dual Post Xcellerator starting platform. Providing the unit is installed correctly and properly maintained, it will furnish you with many years of trouble-free use. It is important to read this entire manual prior to beginning assembly or operation.

Shipping Information:

Each Xcellerator platform frame should arrive assembled on a pallet. Each platform top will be packaged separately. Before accepting the shipment from the carrier, inspect for visible damage and match the contents with those listed below. Spectrum is not responsible for lost or damaged freight.

The pallet will contain all structural components and hardware. The following is a list of the components included with your shipment from Spectrum.

1	Xcellerator Platform Frame	1	Platform Top Assembly Package
---	----------------------------	---	-------------------------------

Components and Hardware

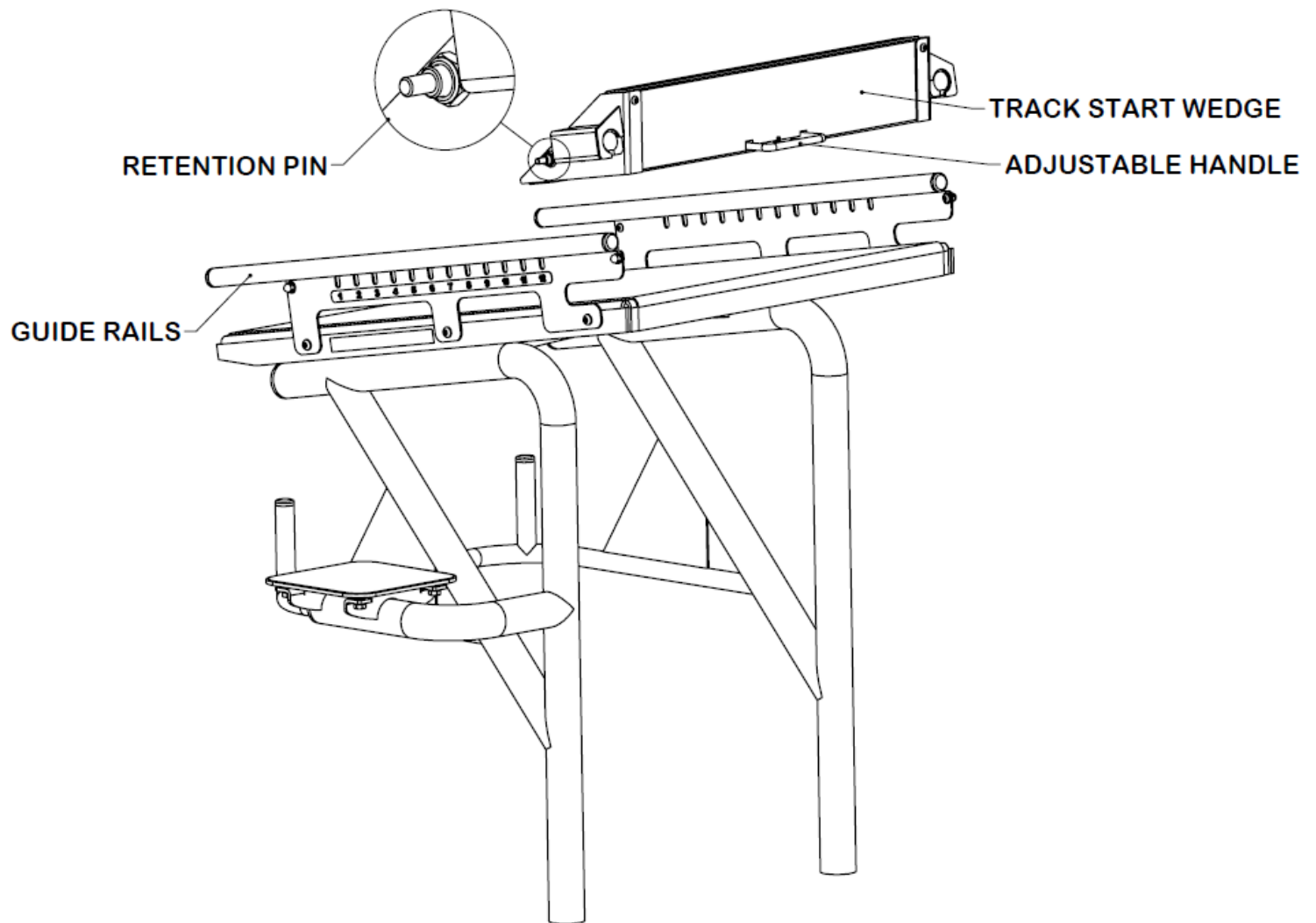

Figure 1

Installation Overview

Read all instructions before attempting to assemble or install your Dual Post Xcellerator starting platform.

Anchor Placement

The measuring guide will aid the installer in determining the proper location of the starting platform on the swimming pool deck. The guide will also provide Spectrum with the information needed to design the starting platform specifically for the customer's pool. Spectrum starting platforms are custom engineered to comply with the regulations of FINA, FR 2.7, USS regulations 103.11.1-6, and NCAA Article 7. It is important that accurate measurements be provided by the project architect/consultant and/or the installer, to assure that the installation of the platform will comply with the foregoing regulations.

NOTE: If platforms are being ordered before pool construction, architectural drawings and specifications will be used for the deck to water level dimensions.

CAUTION: Xcellerator starting platforms should not be installed on swimming pools with water depth less than 4 feet.

The anchor setback distance will need to be determined first. The anchor setback is the distance from the pool wall to the centerline of the anchor. When determining anchor location, architectural specifications take precedence over all other dimensional requirements. If no specifications are given, Spectrum recommends a setback of 30 inches. If a different anchor location is desired, the anchor setback distance can be between 18-35 inches. Any anchor location in this range is acceptable. Anchors should not be placed within 6 inches of obstructions such as expansion joints, seams or cracks in the concrete.

Measuring the Deck-to-Water Profile

Tools Needed:

- 1) Tape measure
- 2) Carpenter's level (At least 3' long)

IMPORTANT: If installing multiple starting platforms on a swimming pool facility, it is imperative that all anchors be installed at the same elevation. It is, therefore, important that the installer determines the highest point of the swimming pool deck and obtains all measurements from that point.

Fill out the deck-to-water profile diagram included. Use the carpenter's level and tape measure to obtain accurate measurements. See Figure 1. The dimension "A" indicates the desired setback. The dimension "B" indicates the distance from the bottom of the carpenter's level to the water surface.

NOTE:

Field measurements are required for the product you wish to order. Please provide product accurate measurements to eliminate delays or errors in the design and manufacturing.

* These dimensions are standard production for Spectrum Aquatics and meet FINA, NCAA, USAS, USMS, and NFHS height requirements. Please contact your Spectrum Aquatics sales representative if you would like to vary these dimensions.

Step side is determined by standing behind your block while facing the pool.

If your deck has a slope, dimension A should be taken from the surface of the water to the level where the starting platform post meets the deck.

\$ Call for additional pricing

SUBMITTED BY: _____ PRINT _____ SIGNATURE _____

DATE: _____

- ☐ REQUEST A FINAL DRAWING
☐ PROCEED WITH PRODUCTION

BY SIGNING ANYPLACE ON THIS SUBMITTAL, YOU ARE APPROVING AS IS - NO CHANGES REQUIRED.

THIS IS YOUR SUBMITTAL. SPECTRUM PRODUCTS HAS MADE EVERY EFFORT TO DESIGN TO YOUR SPECIFICATIONS. PLEASE REVIEW THIS SUBMITTAL THOROUGHLY. SPECTRUM PRODUCTS CANNOT BE RESPONSIBLE FOR ERRORS AFTER THE SUBMITTAL(S) HAS BEEN SIGNED AND APPROVED BY YOU AND/OR YOUR CUSTOMER. PLEASE INSURE ALL DIMENSIONS ARE ACCURATE AND CORRECT. IT IS THE SOLE RESPONSIBILITY OF THE CUSTOMER TO ENSURE THAT THE PRODUCT MEETS ALL APPLICABLE CODES.

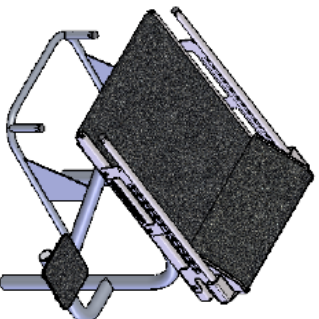

☐ XCELLERATOR DP - BLACK

FRAME

DIMENSION A _____ DIMENSION B _____ DIMENSION C _____
(SETBACK) (WATER DRAFT) (POST CENTER-TO-CENTER)

(PICK ONE)

- ☐ LEFT STEP (SHOWN)
☐ RIGHT STEP

REAR STEP (30" SETBACK MINIMUM)

(PICK ONE)

- ☐ 304L STAINLESS STEEL (STANDARD)
☐ 316L STAINLESS STEEL (\$)
☐ 304L STAINLESS STEEL - POWDER COATED (\$)

POWDER COLOR: _____

(REQUIRED FOR POWDER COATING)

☐ 316L STAINLESS STEEL - POWDER COATED (\$)

POWDER COLOR: _____

(REQUIRED FOR POWDER COATING)

TOP - WEDGE - STEP (COLOR)

☒ CHECK OPTION BELOW

STEP (SIZE)

☒ CHECK OPTION BELOW

NUMBERS

☒ CHECK OPTION RIGHT

CUSTOM NUMBER FONT (\$)

(REQUIRED FOR CUSTOM BLOCK NUMBERING)

COLOR (\$)

BLOCK NUMBERING:

EXAMPLE 01: #1-6 BLOCK #7 LEFT BLANK

EXAMPLE 02: #1-3 LEFT STEP & #4-6 RIGHT STEP

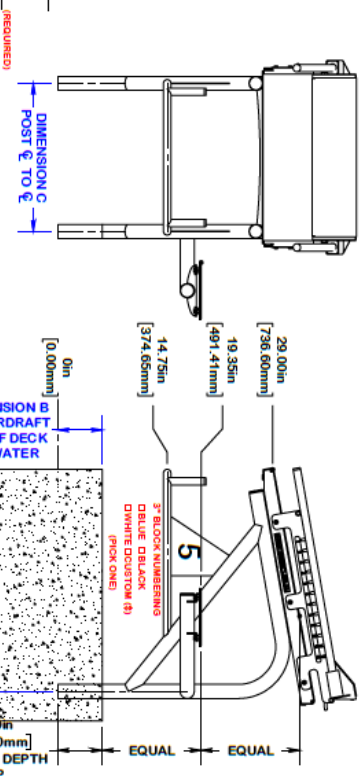

ENSURE DISTANCE OF 6" BETWEEN ϕ ANCHOR LOCATIONS AND EXPANSION JOINTS, EDGES OF SLAB, ETC.

SPECTRUM
Aquatics

A PLAYCORE Company
Missoula, Montana 59808
7100 Spectrum Lane
800.791.8056
www.spectrumaquatics.com

ENGINEERING DATA

PRODUCT:	XCELLERATOR - DP - 30.00 SETBACK 6.00 W.D.		
MODEL #:	133171	CATALOG #:	57282
MATERIAL:	304L STAINLESS STEEL		
FINISH #:	PASSIVATE IAW ASTM A967		
REVISION:	A		

NOTE:
DIMENSIONS VARY WITH SPECIFIC APPLICATIONS. SPECIFICATIONS ARE NOMINAL AND ARE SUBJECT TO CHANGE. PLEASE CONTACT SPECTRUM AQUATICS FOR CUSTOM APPLICATIONS.
SPECIAL REQUESTS:

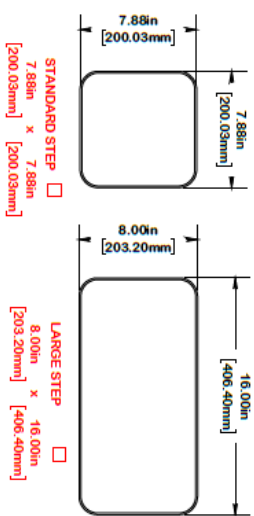

A Wednesday, May 23, 2018 9:33:10 AM

New Construction Anchor Installation

- Determine the desired location for the platform(s). Generally, the starting platform will be installed on center of the racing line tile markers installed in the swimming pool. Refer to the measuring guide for the anchor set back distance. The distance is provided by the architect. If platforms have already been ordered, this dimension may have already been determined. If this is the case, refer to the approved submittal drawings provided by Spectrum.
- Locate a bonding source to bond (ground) the anchor. The steel rebar-bonding grid of the pool deck is the best choice for bonding the anchor. Attach a No. 8 solid copper wire (NEC Section 680-22) from the bonding bolt on the base of the anchor to the bonding grid.
- Secure anchor in place – proper height – anchor may be mudded in place. Set the anchor so that the finished top is flush to deck level.
- Use the carpenter's level to ensure the anchor is vertically plumb.
- Insert anchor cap to make sure concrete does not enter anchor.
- Pour concrete deck and finish. Allow the concrete to cure for at least 7-days before installing and using the unit.

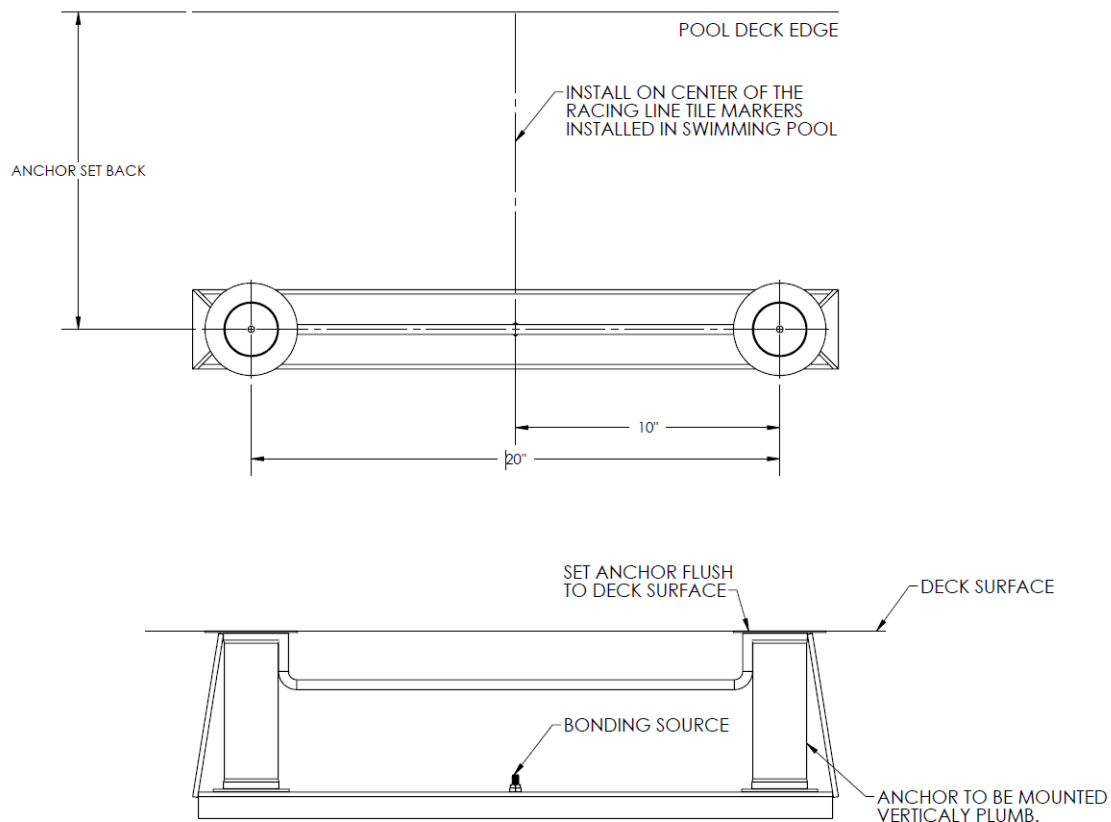

Figure 2

Existing Facility Anchor Installation

- a. From the center of the desired anchor locations, using a marking pen or chalk, mark a 32" x 12" rectangle. This is the concrete to be removed to accommodate the installation of the block's anchors. It is recommended that the anchors are located at least 6" from any expansion joint, crack, drain or similar structure in the concrete deck.
- b. Use a concrete cutting saw; cut a 32" x 12" rectangle out of the existing concrete deck with the anchor's desired centers equidistant from each edge of the rectangular cut out. Using a heavy/sledgehammer, break the cut sections of concrete and remove from the deck. See Figure 3.

Note: If the concrete deck is less than 6" thick, dig out the bottom of the hole to 8" or deeper below the deck surface.

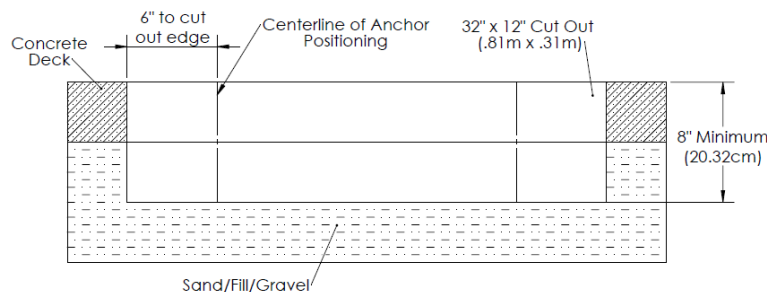

Figure 3

- c. Locate a bonding source to bond (ground) the anchors. The steel rebar-bonding grid of the pool deck is the best choice for bonding the anchors. Attach a No. 8 solid copper wire (NEC Section 680-22) from the bonding bolt on the base of the anchors to the bonding grid.

Note: If the concrete deck is 8" thick or more, an alternative anchor installation method may be used. In lieu of cutting the concrete deck with a saw, a concrete core drill may be employed to cut 4" diameter holes at the desired anchor installation locations. Epoxy or hydraulic cement may be used to secure the anchors in place. Make sure the anchors are properly bonded.

- d. Secure anchors in place – proper height – anchors may be cemented in place. Set the anchors so that the finished top is 1/8" to 1/4" below finished deck level – allowing for anchor caps to be put in place when the platform is not in use.
- e. Use the carpenter's level to level the anchors, making sure the Xcellerator mast will be vertically straight up and down (perpendicular to the deck) in all directions. It is important that the mast is vertically straight to ensure proper platform functionality.
- f. Place tape over the anchor hole before pouring concrete deck to prevent concrete from entering the anchor opening.
- g. Pour concrete deck and finish, allowing 7-days minimum for the concrete to cure before installation and use of the unit.

Assembly Instruction

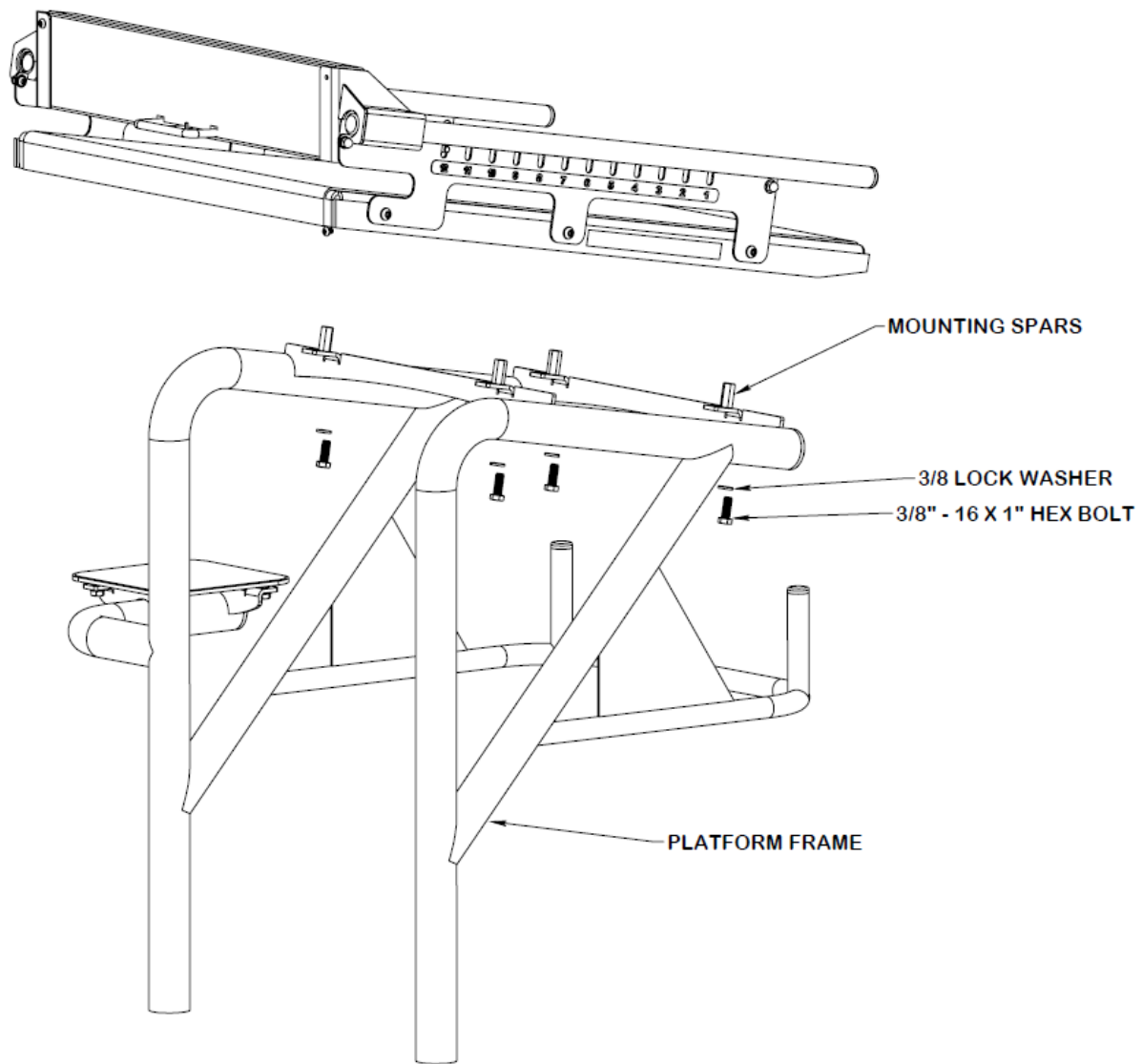

Figure 4

The Xcellerator platform ships partially assembled. The platform top will ship fully assembled in a box attached to the pallet containing the platform frame. Attachment of the platform tops will require two tools, a 9/16" wrench or socket and a non-marring plastic mallet. To install the platform top, place the platform frame in an anchor socket and position the platform top over the mounting spars. Secure at least (2) of the mounting points using the included 3/8"-16x1" hex cap bolts and lock washers. At this point, it may be necessary to adjust the mounting spars using a non-marring mallet to achieve alignment of the remaining mounting locations. Once all locations are secured with the included hardware, tighten all bolts. It is advisable to use an anti-seize coating when installing stainless steel hardware.

Operator's Guide

Install Starting Platforms

!Caution! Starting platforms are heavy; use caution when moving or lifting especially near pool edges.

!Caution! Ensure retention pins are secured in the guide rail alignment slots before use. Failing to do so may result in damage to the starting platform/wedge and/or injury.

Remove the anchor lids. Slide the Xcellerator starting platform support posts into their respective anchor. Step up onto the platform top and bounce forward, back and side-to-side to test for stability on the platform.

The track start wedge may be moved by pulling firmly on the adjustment handle. Numbered locking positions are provided to ensure all track start wedges are in the same position on all platforms.

Removing the Xcellerator Starting Platform

Using the support post as a grip, pull the platform straight up and out of the anchors. Once the platform is free of the anchor the cap may be replaced. Platform removal is safer and easier when performed as a team.

Note: Removal will become less difficult after the block and anchor progress through a break-in period.

Care and Maintenance

The following should be performed periodically to ensure safe and dependable use.

1. Remove any discoloration with a 3M scratch pad (stainless steel components only). Wipe clean with a sponge dampened with Spectra-Clean. Repeat these steps several times to passivate the stainless steel. Maintenance kits are available from Spectrum (Part Number 152155). Do not spray with high-pressure water, only clean with non-chlorinated water.
2. Check all mechanical connections – inspect fasteners and make sure they are secure.

Troubleshooting

Problem	Cause	Solution
Track start wedge won't move or won't stay in place	Faulty retention pins	Replace retention pins
Nonslip surface becomes Worn	Regular use / weathering	Contact distributor or Spectrum Products

Please contact your local distributor or Spectrum Customer Service to order parts 406.532.6321

Expansion Block Lock

The Spectrum “Expansion Block Lock” is how you will anchor your Round Dual Post starting block into the ground. With proper installation and maintenance, this product will provide you with years of trouble-free use. Before installation and use, be sure to read through the associated product documentation in its entirety.

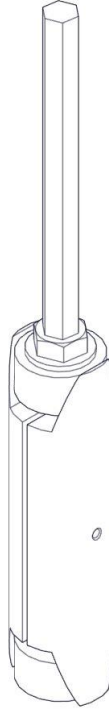

Figure 5

Images in the following manual may vary slightly from delivered product based on application.

Shipping Information:

Each Expansion Block Lock System will arrive assembled in one box. Before accepting the lift from the carrier, inspect for visible damage and match the contents with those listed below. Spectrum is not responsible for lost or damaged freight.

The box will contain all structural components and hardware. The following is a list of the components included with your shipment from Spectrum. Use Components and Hardware Figure 6, page 10, as a reference to identify each item listed.

2	BLOCK LOCK WEDGE TOP (unthreaded)	8	WASHER FW ½"
2	BLOCK LOCK WEDGE BOTTOM (threaded)		
2	BLOCK LOCK BOLT		
2	BLOCK LOCK CLAMP HALF		
2	SCREW SS #10-24x1/2"		

Components and Hardware

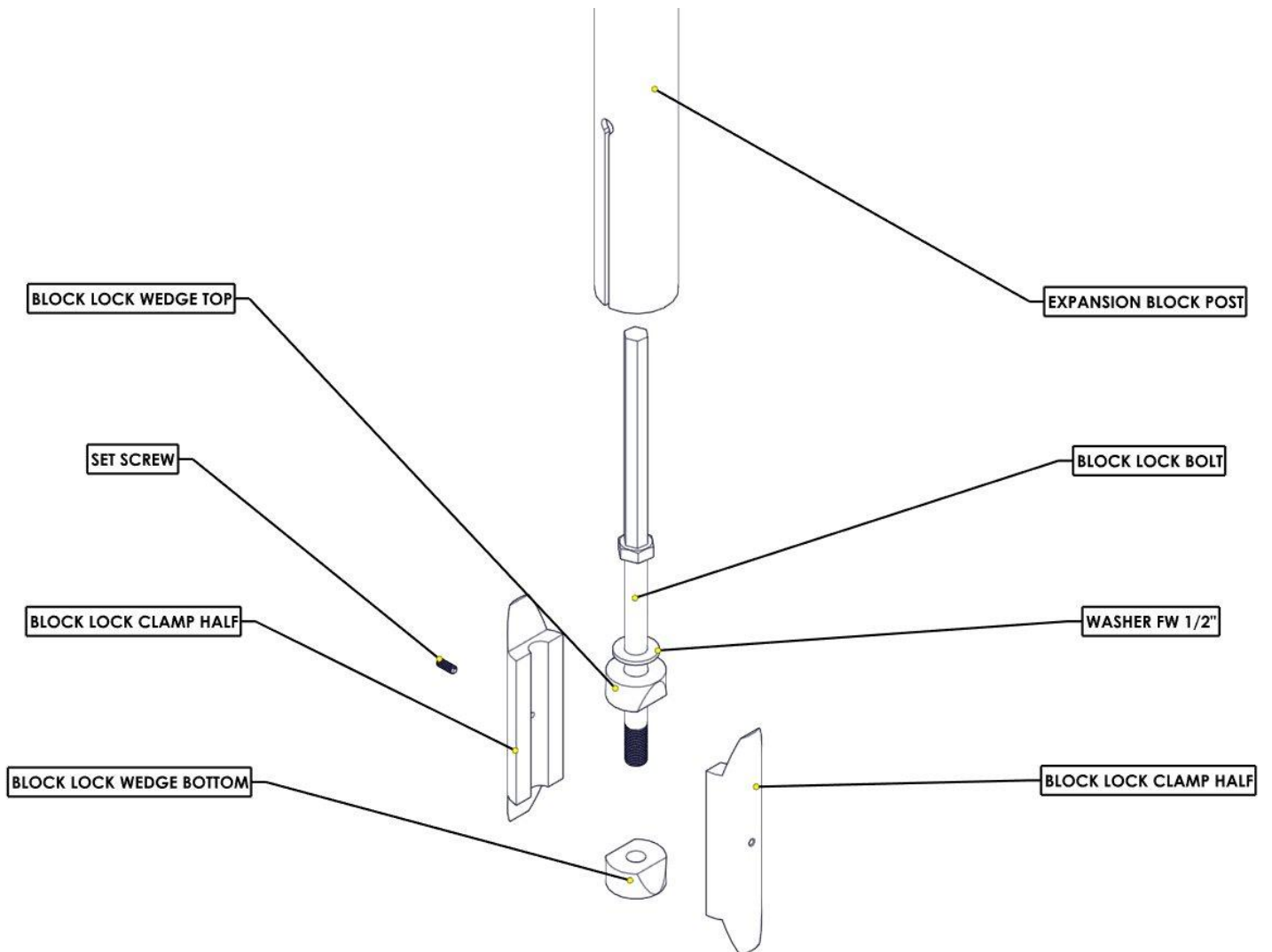

Figure 6

Installation Overview

The following tools will be required to install and operate the assembly:

-3/32" Hex Key

-1/2" Ratcheting Wrench

The Spectrum Expansion Block Lock should arrive assembled. If you need to re-assemble the system, and exploded view can be shown below:

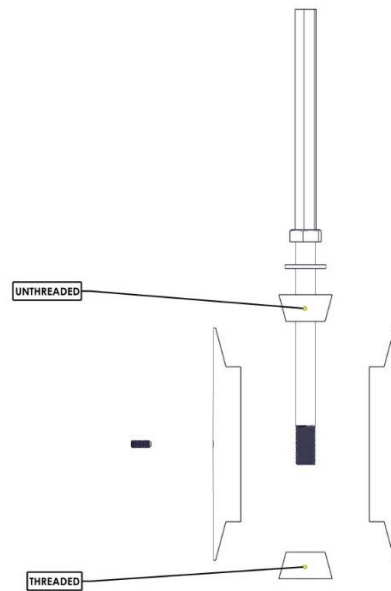

Figure 7

- a. Begin installation by driving the set screw so that the surface is flush with the Block Lock Clamp Surface. Ensure that the block lock bolt has been slightly screwed into the threaded wedge bottom. Place the assembly into the anchor post of the starting block.

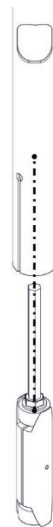

Figure 8

- b. After placing the assembly, line-up the set screw with the thru hole in the anchor post. Back out the set screw just enough to partially protrude through the hole in the anchor post using a 3/32" hex key to locate the assembly within the anchor post.

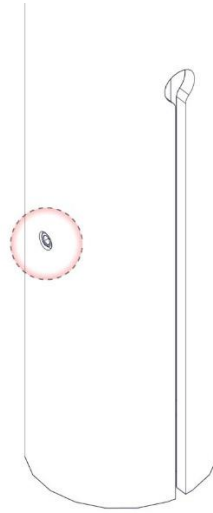

Figure 9

- c. Once the block lock assembly is in place, make sure to check that the top of the block lock bolt can be accessed from the adjustment window of the anchor post. If the bolt needs to be raised slightly, remove the assembly, add additional 1/2" flat washers for height and replace the assembly.
- d. Repeat this process for the second anchor post as well as any other blocks being installed.

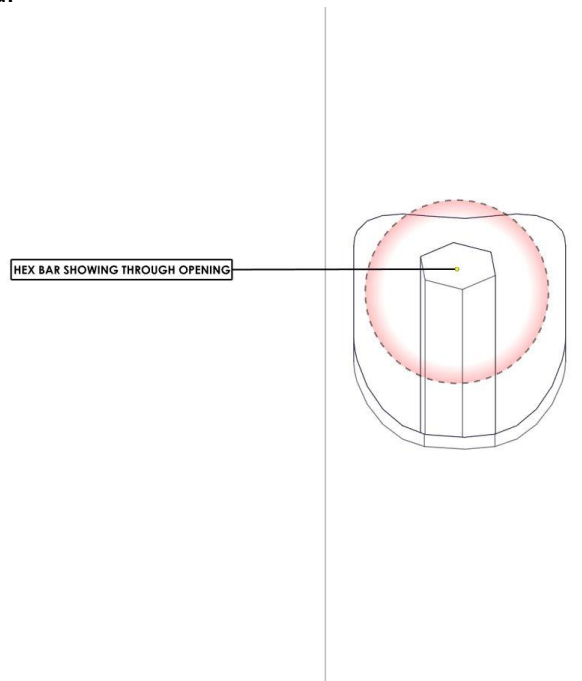

Figure 10

Operator's Guide

- a. Place the starting block with installed block lock assemblies into the anchor on deck, ensuring that the block is entirely settled before engaging the expansion block lock system.
- b. Engage the system by tightening both block lock bolts for the starting platform using a ½" ratcheting wrench until all excess space has been removed from the anchor and the block does not wobble.
- c. To remove the starting block from the anchor, disengage the system by loosening the block lock bolts using a ½" ratcheting wrench until the block lock bolts do not give any further resistance. **DO NOT OVER LOOSEN THE BLOCK LOCK BOLTS; SYSTEM WILL DISASSEMBLE WITHIN THE ANCHOR.**
- d. Note that it may take some force to remove the starting block from the anchors even when the system is fully disengaged.

Care and Maintenance

Semi-annually, remove the system from the block anchor posts. Inspect all threads to ensure there is no damage to the system. Check for any signs of corrosion and clean all components using a 3M abrasive pad to ensure continued functionality.

Troubleshooting

Problem:	Cause:	Solution:
When the system is tightened, the starting block rises slightly	Block Lock Bolt Pressing against bottom of the anchor	Place additional ½" washers between block lock bolt and block lock wedge top
Block Lock Bolt is not tightening or giving resistance	Block Lock Bolt is not engaged into Block Lock Wedge bottom	Remove the system, ensure the block lock bolt is slightly screwed into the Block Lock Wedge bottom before install
Block Lock bolt is not screwing into Block Lock Wedge Bottom	Threads on one or both parts of the system are damaged	Order new parts from Spectrum Aquatics to repair the system