

**Compression Anchor Cap shall be part number 24092-00.**

**The Key shall be part number 23636-00.**

The anchor cap shall be designed to cover the opening of a part number 24092 compression anchor. An anchor cap removal key shall be provided and will facilitate the removal of the anchor cap. The anchor shall be installed to allow the anchor cap to be flush with finish.

#### **Anchor Cap**

The anchor cap tube shall be fabricated of 300 series stainless steel. The anchor cap disc shall be fabricated of 300 series stainless steel. The disc shall be T.I.G. welded the tube.

The anchor cap shall be 2 1/2" in diameter and shall extend 1" into the compression anchor body.

#### **Removal Key**

A stainless steel anchor cap removal key shall be provided. The key shall be fabricated of 300 series stainless steel round rod, 3/16" in diameter. The key shall be 3" in length with 1/2" keyed ends

#### **Warranty**

Two year limited warranty.

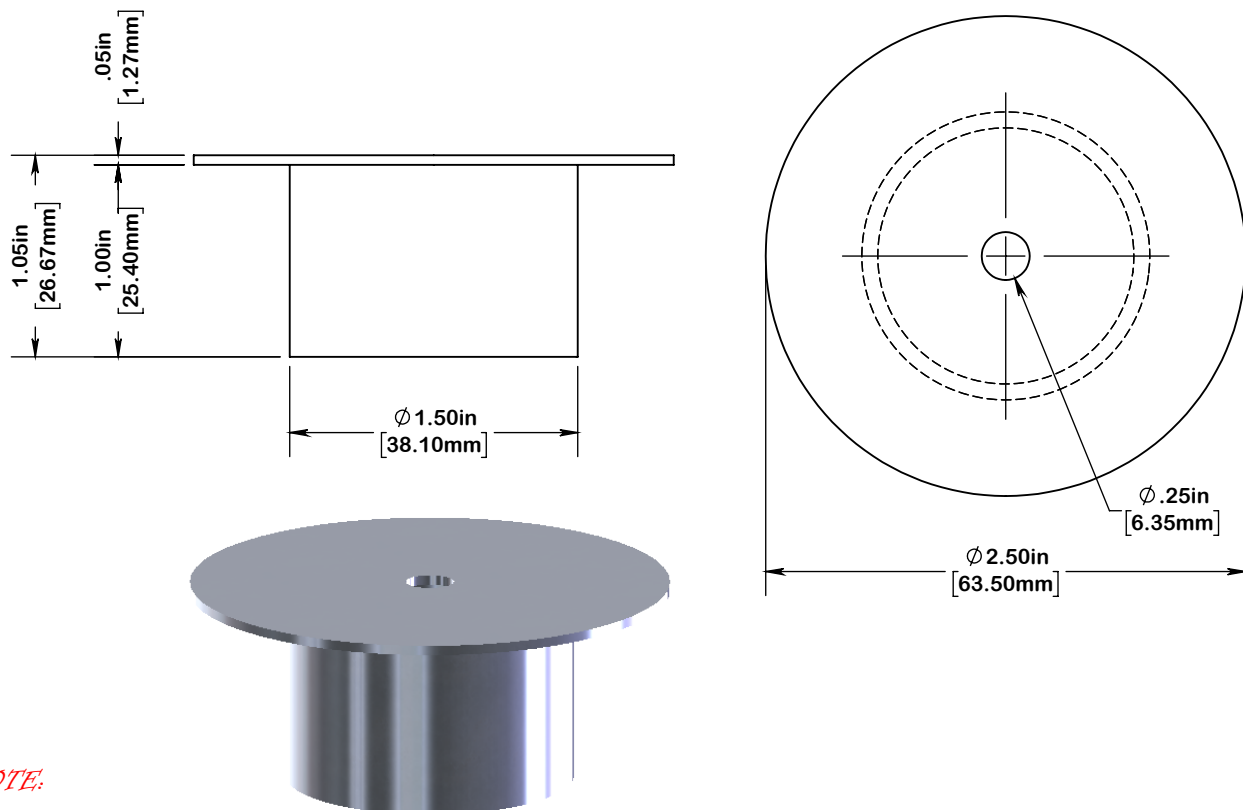

*NOTE:*

*⚠ DIMENSIONS VARY WITH SPECIFIC APPLICATIONS. SPECIFICATIONS ARE NOMINAL AND ARE SUBJECT TO CHANGE. PLEASE CONTACT SPECTRUM AQUATICS FOR CUSTOM APPLICATIONS*

**SPECTRUM**  
Aquatics

A PLAYCORE Company

7100 Spectrum Lane  
Missoula, Montana 59808  
800.791.8056

[www.spectrumaquatics.com](http://www.spectrumaquatics.com)

## *ENGINEERING DATA*

PRODUCT:	ANCHOR CAP - COMPRESSION 1.5 -			
MODEL #:	24098	CATALOG #:	24098	REVISION: A
MATERIAL:	304 - 316L STAINLESS STEEL			
FINISH #:	600 GRIT			